



ESTADO DO CEARÁ
CÂMARA MUNICIPAL DE PACATUBA

CÂMARA MUNICIPAL DE PACATUBA-CE
APROVADO 10/04/2023

Raquel Pinto Cavalcante
1º Secretário

PROJETO DE LEI Nº. 10.04.00010/2023, DE 10 DE ABRIL DE 2023.

CÂMARA MUNICIPAL DE PACATUBA-CE
PROJETO DE LEI PROTOCOLADO
EM: 10/04/2023

CÂMARA MUNICIPAL DE PACATUBA-CE
Antônia Joselice Camilo Martins
Diretora Geral

IDENTIFICA OFICIALMENTE COM A
NUMERAÇÃO E A IDENTIFICAÇÃO DO
CÓDIGO DE ENDEREÇAMENTO POSTAL -
CEP OS LOGRADOUROS DO
LOTEAMENTO DA BOA VIZINHANÇA -
LOCALIZADO NO CONJUNTO
BANDEIRANTES – PACATUBA – CE.

O PREFEITO MUNICIPAL DE PACATUBA – ESTADO DO CEARÁ, faz saber
que a Câmara Municipal de Pacatuba, aprovou e eu sanciono a seguinte Lei:

Art. 1º - Fica identificado oficialmente a numeração dos Logradouros do Loteamento da Boa Vizinhança - Localizado no Conjunto Bandeirantes – Pacatuba – CE.

Art. 2º - A referida identificação deverá conter a NUMERAÇÃO, por Quadra em toda extensão, iniciando Rua 01, com a seguinte identificação: RUA 01; RUA 02; seguindo sua sequência sucessivamente, até finalizarem todas as Quadras com a respectiva numeração e posterior implantação do Código de Endereçamento Postal – CEP. Conforme CRCRIS demonstrativo das seguintes Quadras. (VIAS ANEXAS).

Art. 3º - A identificação decorre do fato da Empresa Brasileira dos Correios e Telégrafos, implementar o Código de Endereçamento Postal das Ruas do Loteamento.

Art. 4º - Esta Lei entra em vigor na data de sua publicação.

Art. 5º - Revogam- se as disposições em contrário.

PAÇO DA CÂMARA MUNICIPAL DE PACATUBA, aos 10 de abril de 2023.

FLAUDENOR JACINTO DA SILVA- PROGRESSISTAS
VEREADOR

Rua Major Crisanto de Almeida, 195 – Bairro Centro CEP: 61.801-205 – Fones (85) 3345-1284.
Site: www.cmpacatuba.ce.gov.br Email: camaramunicipaldepacatuba@gmail.com
E-mail Institucional contato@cmpacatuba.ce.gov.br



ESTADO DO CEARÁ
CÂMARA MUNICIPAL DE PACATUBA

JUSTIFICATIVA

O presente Projeto ora apresentado de autoria do Exmo. Sr. Vereador Flaudenor Jacinto da Silva – Partido Progressistas – PP, pretende junto ao Poder Executivo Municipal e Secretaria Municipal da Infraestrutura e Empresa Brasileira dos Correios e Telégrafos, viabilizarem a **IDENTIFICAÇÃO** dos Logradouros do Loteamento da Boa Vizinhaça, localizado no Conjunto Bandeirantes – Pacatuba – CE.

A necessidade de elaborar o Projeto, se dá ao fato dos referidos logradouros, não conterem a identificação causando grande transtorno aos moradores, que residem na localidade, dificultando principalmente a entrega das correspondências.

A Empresa Brasileira de Correios e Telégrafos – ECT, ficará a cargo de viabilizar a implantação do Código de Endereçamento Postal – CEP, de cada Logradouro de todas as Quadras do referido Loteamento.

PAÇO DA CÂMARA MUNICIPAL DE PACATUBA, aos 10 de abril de 2023.

FLAUDENOR JACINTO DA SILVA - PROGRESSISTAS
VEREADOR/REQUERENTE



PROJECT: [Illegible]
DATE: [Illegible]
SCALE: [Illegible]

10'

| NO. | DESCRIPTION | DATE |
|-----|-------------|-------------|
| 1 | [Illegible] | [Illegible] |
| 2 | [Illegible] | [Illegible] |
| 3 | [Illegible] | [Illegible] |
| 4 | [Illegible] | [Illegible] |
| 5 | [Illegible] | [Illegible] |
| 6 | [Illegible] | [Illegible] |
| 7 | [Illegible] | [Illegible] |
| 8 | [Illegible] | [Illegible] |
| 9 | [Illegible] | [Illegible] |
| 10 | [Illegible] | [Illegible] |
| 11 | [Illegible] | [Illegible] |
| 12 | [Illegible] | [Illegible] |
| 13 | [Illegible] | [Illegible] |
| 14 | [Illegible] | [Illegible] |
| 15 | [Illegible] | [Illegible] |
| 16 | [Illegible] | [Illegible] |
| 17 | [Illegible] | [Illegible] |
| 18 | [Illegible] | [Illegible] |
| 19 | [Illegible] | [Illegible] |
| 20 | [Illegible] | [Illegible] |
| 21 | [Illegible] | [Illegible] |
| 22 | [Illegible] | [Illegible] |
| 23 | [Illegible] | [Illegible] |
| 24 | [Illegible] | [Illegible] |
| 25 | [Illegible] | [Illegible] |
| 26 | [Illegible] | [Illegible] |
| 27 | [Illegible] | [Illegible] |
| 28 | [Illegible] | [Illegible] |
| 29 | [Illegible] | [Illegible] |
| 30 | [Illegible] | [Illegible] |
| 31 | [Illegible] | [Illegible] |
| 32 | [Illegible] | [Illegible] |
| 33 | [Illegible] | [Illegible] |
| 34 | [Illegible] | [Illegible] |
| 35 | [Illegible] | [Illegible] |
| 36 | [Illegible] | [Illegible] |
| 37 | [Illegible] | [Illegible] |
| 38 | [Illegible] | [Illegible] |
| 39 | [Illegible] | [Illegible] |
| 40 | [Illegible] | [Illegible] |
| 41 | [Illegible] | [Illegible] |
| 42 | [Illegible] | [Illegible] |
| 43 | [Illegible] | [Illegible] |
| 44 | [Illegible] | [Illegible] |
| 45 | [Illegible] | [Illegible] |
| 46 | [Illegible] | [Illegible] |
| 47 | [Illegible] | [Illegible] |
| 48 | [Illegible] | [Illegible] |
| 49 | [Illegible] | [Illegible] |
| 50 | [Illegible] | [Illegible] |
| 51 | [Illegible] | [Illegible] |
| 52 | [Illegible] | [Illegible] |
| 53 | [Illegible] | [Illegible] |
| 54 | [Illegible] | [Illegible] |
| 55 | [Illegible] | [Illegible] |
| 56 | [Illegible] | [Illegible] |
| 57 | [Illegible] | [Illegible] |
| 58 | [Illegible] | [Illegible] |
| 59 | [Illegible] | [Illegible] |
| 60 | [Illegible] | [Illegible] |
| 61 | [Illegible] | [Illegible] |
| 62 | [Illegible] | [Illegible] |
| 63 | [Illegible] | [Illegible] |
| 64 | [Illegible] | [Illegible] |
| 65 | [Illegible] | [Illegible] |
| 66 | [Illegible] | [Illegible] |
| 67 | [Illegible] | [Illegible] |
| 68 | [Illegible] | [Illegible] |
| 69 | [Illegible] | [Illegible] |
| 70 | [Illegible] | [Illegible] |
| 71 | [Illegible] | [Illegible] |
| 72 | [Illegible] | [Illegible] |
| 73 | [Illegible] | [Illegible] |
| 74 | [Illegible] | [Illegible] |
| 75 | [Illegible] | [Illegible] |
| 76 | [Illegible] | [Illegible] |
| 77 | [Illegible] | [Illegible] |
| 78 | [Illegible] | [Illegible] |
| 79 | [Illegible] | [Illegible] |
| 80 | [Illegible] | [Illegible] |
| 81 | [Illegible] | [Illegible] |
| 82 | [Illegible] | [Illegible] |
| 83 | [Illegible] | [Illegible] |
| 84 | [Illegible] | [Illegible] |
| 85 | [Illegible] | [Illegible] |
| 86 | [Illegible] | [Illegible] |
| 87 | [Illegible] | [Illegible] |
| 88 | [Illegible] | [Illegible] |
| 89 | [Illegible] | [Illegible] |
| 90 | [Illegible] | [Illegible] |
| 91 | [Illegible] | [Illegible] |
| 92 | [Illegible] | [Illegible] |
| 93 | [Illegible] | [Illegible] |
| 94 | [Illegible] | [Illegible] |
| 95 | [Illegible] | [Illegible] |
| 96 | [Illegible] | [Illegible] |
| 97 | [Illegible] | [Illegible] |
| 98 | [Illegible] | [Illegible] |
| 99 | [Illegible] | [Illegible] |
| 100 | [Illegible] | [Illegible] |

| NO. | DESCRIPTION | DATE |
|-----|-------------|-------------|
| 1 | [Illegible] | [Illegible] |
| 2 | [Illegible] | [Illegible] |
| 3 | [Illegible] | [Illegible] |
| 4 | [Illegible] | [Illegible] |
| 5 | [Illegible] | [Illegible] |
| 6 | [Illegible] | [Illegible] |
| 7 | [Illegible] | [Illegible] |
| 8 | [Illegible] | [Illegible] |
| 9 | [Illegible] | [Illegible] |
| 10 | [Illegible] | [Illegible] |
| 11 | [Illegible] | [Illegible] |
| 12 | [Illegible] | [Illegible] |
| 13 | [Illegible] | [Illegible] |
| 14 | [Illegible] | [Illegible] |
| 15 | [Illegible] | [Illegible] |
| 16 | [Illegible] | [Illegible] |
| 17 | [Illegible] | [Illegible] |
| 18 | [Illegible] | [Illegible] |
| 19 | [Illegible] | [Illegible] |
| 20 | [Illegible] | [Illegible] |
| 21 | [Illegible] | [Illegible] |
| 22 | [Illegible] | [Illegible] |
| 23 | [Illegible] | [Illegible] |
| 24 | [Illegible] | [Illegible] |
| 25 | [Illegible] | [Illegible] |
| 26 | [Illegible] | [Illegible] |
| 27 | [Illegible] | [Illegible] |
| 28 | [Illegible] | [Illegible] |
| 29 | [Illegible] | [Illegible] |
| 30 | [Illegible] | [Illegible] |
| 31 | [Illegible] | [Illegible] |
| 32 | [Illegible] | [Illegible] |
| 33 | [Illegible] | [Illegible] |
| 34 | [Illegible] | [Illegible] |
| 35 | [Illegible] | [Illegible] |
| 36 | [Illegible] | [Illegible] |
| 37 | [Illegible] | [Illegible] |
| 38 | [Illegible] | [Illegible] |
| 39 | [Illegible] | [Illegible] |
| 40 | [Illegible] | [Illegible] |
| 41 | [Illegible] | [Illegible] |
| 42 | [Illegible] | [Illegible] |
| 43 | [Illegible] | [Illegible] |
| 44 | [Illegible] | [Illegible] |
| 45 | [Illegible] | [Illegible] |
| 46 | [Illegible] | [Illegible] |
| 47 | [Illegible] | [Illegible] |
| 48 | [Illegible] | [Illegible] |
| 49 | [Illegible] | [Illegible] |
| 50 | [Illegible] | [Illegible] |
| 51 | [Illegible] | [Illegible] |
| 52 | [Illegible] | [Illegible] |
| 53 | [Illegible] | [Illegible] |
| 54 | [Illegible] | [Illegible] |
| 55 | [Illegible] | [Illegible] |
| 56 | [Illegible] | [Illegible] |
| 57 | [Illegible] | [Illegible] |
| 58 | [Illegible] | [Illegible] |
| 59 | [Illegible] | [Illegible] |
| 60 | [Illegible] | [Illegible] |
| 61 | [Illegible] | [Illegible] |
| 62 | [Illegible] | [Illegible] |
| 63 | [Illegible] | [Illegible] |
| 64 | [Illegible] | [Illegible] |
| 65 | [Illegible] | [Illegible] |
| 66 | [Illegible] | [Illegible] |
| 67 | [Illegible] | [Illegible] |
| 68 | [Illegible] | [Illegible] |
| 69 | [Illegible] | [Illegible] |
| 70 | [Illegible] | [Illegible] |
| 71 | [Illegible] | [Illegible] |
| 72 | [Illegible] | [Illegible] |
| 73 | [Illegible] | [Illegible] |
| 74 | [Illegible] | [Illegible] |
| 75 | [Illegible] | [Illegible] |
| 76 | [Illegible] | [Illegible] |
| 77 | [Illegible] | [Illegible] |
| 78 | [Illegible] | [Illegible] |
| 79 | [Illegible] | [Illegible] |
| 80 | [Illegible] | [Illegible] |
| 81 | [Illegible] | [Illegible] |
| 82 | [Illegible] | [Illegible] |
| 83 | [Illegible] | [Illegible] |
| 84 | [Illegible] | [Illegible] |
| 85 | [Illegible] | [Illegible] |
| 86 | [Illegible] | [Illegible] |
| 87 | [Illegible] | [Illegible] |
| 88 | [Illegible] | [Illegible] |
| 89 | [Illegible] | [Illegible] |
| 90 | [Illegible] | [Illegible] |
| 91 | [Illegible] | [Illegible] |
| 92 | [Illegible] | [Illegible] |
| 93 | [Illegible] | [Illegible] |
| 94 | [Illegible] | [Illegible] |
| 95 | [Illegible] | [Illegible] |
| 96 | [Illegible] | [Illegible] |
| 97 | [Illegible] | [Illegible] |
| 98 | [Illegible] | [Illegible] |
| 99 | [Illegible] | [Illegible] |
| 100 | [Illegible] | [Illegible] |

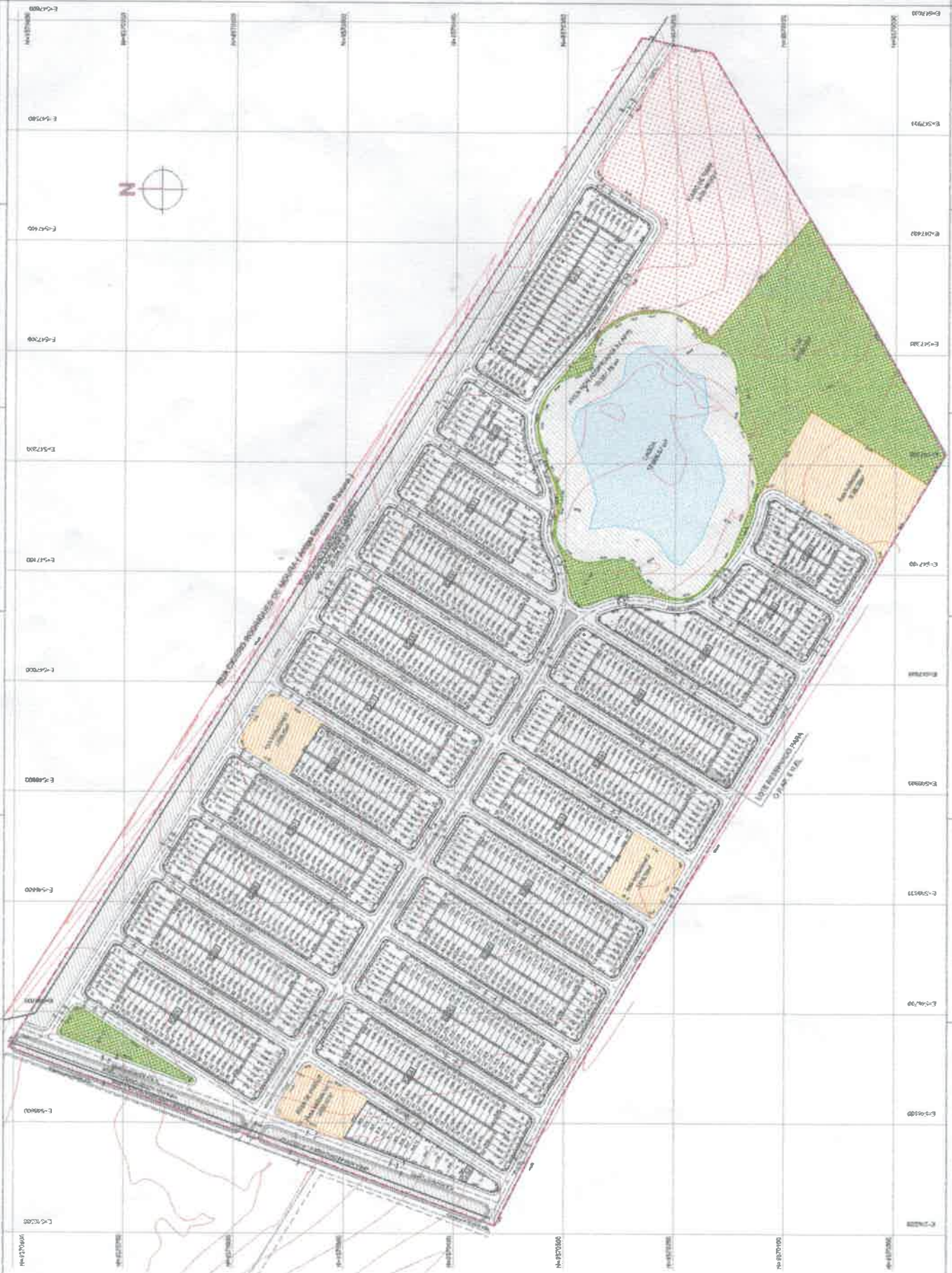
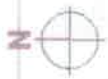

| DATOS GENERALES DEL PROYECTO | |
|------------------------------|--|
| 1. NOMBRE DEL PROYECTO | REDES DE SANEAMIENTO Y AGUA POTABLE PARA LA ZONA DE LA ESCUELA DE PRIMARIA N° 1000 |
| 2. UBICACION DEL PROYECTO | PARQUE ROSARIO, DISTRITO DE SAN JOSE DE LOS RIOS, PROVINCIA DE LOS RIOS, GUAYACAN |
| 3. CLIENTE | COMITE DE MANUTENCION DEL DISTRITO DE SAN JOSE DE LOS RIOS |
| 4. FECHA DE ELABORACION | 15/05/2014 |
| 5. ESCALA | 1:1000 |
| 6. AUTORES | ING. JUAN CARLOS GARCIA, ING. JUAN CARLOS GARCIA, ING. JUAN CARLOS GARCIA |
| 7. APROBACION | ING. JUAN CARLOS GARCIA, ING. JUAN CARLOS GARCIA, ING. JUAN CARLOS GARCIA |
| 8. OBSERVACIONES | |

| LEGENDA | |
|---------|---|
| --- | LINEA DE SANEAMIENTO |
| --- | LINEA DE AGUA POTABLE |
| --- | LINEA DE SANEAMIENTO Y AGUA POTABLE |
| --- | LINEA DE SANEAMIENTO Y AGUA POTABLE (ALTERNATIVA) |
| --- | LINEA DE SANEAMIENTO Y AGUA POTABLE (ALTERNATIVA) |

LINEA DE SANEAMIENTO
 LINEA DE AGUA POTABLE
 LINEA DE SANEAMIENTO Y AGUA POTABLE
 LINEA DE SANEAMIENTO Y AGUA POTABLE (ALTERNATIVA)

| DATOS DEL PROYECTO | |
|---------------------------|--|
| 1. NOMBRE DEL PROYECTO | REDES DE SANEAMIENTO Y AGUA POTABLE PARA LA ZONA DE LA ESCUELA DE PRIMARIA N° 1000 |
| 2. UBICACION DEL PROYECTO | PARQUE ROSARIO, DISTRITO DE SAN JOSE DE LOS RIOS, PROVINCIA DE LOS RIOS, GUAYACAN |
| 3. CLIENTE | COMITE DE MANUTENCION DEL DISTRITO DE SAN JOSE DE LOS RIOS |
| 4. FECHA DE ELABORACION | 15/05/2014 |
| 5. ESCALA | 1:1000 |
| 6. AUTORES | ING. JUAN CARLOS GARCIA, ING. JUAN CARLOS GARCIA, ING. JUAN CARLOS GARCIA |
| 7. APROBACION | ING. JUAN CARLOS GARCIA, ING. JUAN CARLOS GARCIA, ING. JUAN CARLOS GARCIA |
| 8. OBSERVACIONES | |

LINEA DE SANEAMIENTO
 LINEA DE AGUA POTABLE
 LINEA DE SANEAMIENTO Y AGUA POTABLE
 LINEA DE SANEAMIENTO Y AGUA POTABLE (ALTERNATIVA)



ARGENTINA S. URBANISMO
 Ingeniería y Arquitectura
 CARRERA 14, TORRE 1, OFICINA 1001
 GUAYACAN, GUAYAS
 TEL: 051 3 333 3333
 WWW.ARGENTINA.S.UBRANISMO.COM

